



The Fitting Connection

January 2010



PHCC Lunch Meeting

January 19, 2010

Brookhaven Country Club

3333 Golfing Green Drive

Dallas, TX 75287

11:30—1:00 pm

PHCC North Texas

4340 Highlander Drive

Dallas, Texas 75287

972-818-1990

972-818-2105-fax

www.phccnorthtexas.org

January Lunch Meeting

The PHCC North Texas January lunch meeting will be January 19th. Our guest speakers will be Doug Turner, PHCC Texas President, Nancy Jones, PHCC Executive Director, Jane Hanna, CEF (Construction Education Foundation) and Todd Iocco (Green Plumber Instructor). Come find out more about the new Apprentice Code and OSHA training that will be required as of Feb. 1, 2010. Also, they will discuss the Apprentice Program and the Green Plumbing Certification which is available in the DFW area. Don't miss this one!

Please don't forget to use the fax back page (17) to let me know that you plan to attend. Please invite any Contractor that hasn't been attending or who hasn't been to a meeting to join us.

Annual Texas Hold'em Party—January 22nd

PHCC North Texas' Annual Texas Hold'em Party is approaching. If you have not signed up to plan, there is a form on page 6 and a sponsor form on page 5.

Thank you to our Sponsors!!!

APHCC-Texas

Atmos Energy

Classic Chevrolet

Howard F. Kane Plumbing

Lubrizol

ProStar Marketing

Symmons

Teter's Faucet Parts



State Talk From Nancy

*Nancy Jones
PHCC Texas Executive Director*

PHCC TEXAS WISHES THE NORTH TEXAS CHAPTER
A VERY HAPPY AND PROSPEROUS NEW YEAR!

I am sorry I missed your November chapter meeting! My assistant and I were headed to the airport to fly to your meeting when (WHAM!) we were sideswiped by a guy running a red light. It totaled my car, and we were a little banged up, but nothing broken. We hated to miss your meeting, **but we'll be back this month and are looking forward to it! Topics we'll be discussing:**

Our next Apprentice 1-A Class:

Date: March 29-April 1, 2010

Place: CEF—Irving

Time: 7 am—5:30 pm

Cost: Tuition and meals—\$550

If you have a good apprentice who deserves quality training, this is the right program for him! Thanks to all of you North Texas Members who have enrolled apprentices in our classes—we hope some of you will talk about your experiences **at this month's meeting. To sign up your apprentice, call me at (800) 831-9313 (ext 204.)** Or you can sign up at this meeting! Companies are not invoiced until the class is completed. Jane Hanna (CEF) will join us to discuss this program.

Continued...

Green Plumbing Certification:

PHCC Texas is bringing Green Plumbing to Dallas:

Dates:

February 26 Climate Care

March 12 Caring for Our Water

April 9 Water Efficient Technology

(A date will be set later for Inspection Reports & Solar Hot Water)

Time: 9:00 am—6:00 pm

Cost: PHCC Members \$140.00 per class
Non-Member \$175.00 per class

Todd Iocco, our Green Plumbing Instructor (trained in Sacramento, California) will be here to explain the program in detail. He will tell you that you will become a local expert on conservation measures in residential and commercial training, which will enhance your public image and increase **your bottom line. You don't want to miss hearing all about this great new program!** We have already heard from many of you who want to become **"Green Plumber Certified."**

PHCC Texas News:

Doug Turner (Doug Turner Plumbing, Sugar Land,) 2010 PHCC Texas President, and Nancy Jones will discuss new happenings on the state level which will affect you, our member. (New required code training classes for apprentices, residential fire sprinkler training, state convention, etc.)

PLAN TO BE THERE!!!!



Surpassing Expectations

A TRUE FULL LINE, ONE STOP
SUPPLY HOUSE FOR ALL YOUR
PIPE, VALVE, AND
FIXTURE NEEDS.
"WE HAVE IT ALL"



**2355 Pecan Court
Haltom City, TX 76117**

**Local: 817.288.8891
Metro: 214.580.1292**



Add-A-Hanger

- Attaches 1/2" 3/4" 1" tubing to all thread rod.
- Twists on & off. Tubes snap in & out.
- UL rated for air-handling spaces.
- Call for free samples, literature & a list of local stocking wholesalers.

Phone: 1-800-325-8739.

pipe-tytes[®]
INC.

Manufacturing plumbing products since 1978.
9050 16th Street Vero Beach Florida 32966
Phone: 1-800-325-8739 Fax: 1-866-576-6200
www.pipetytes.com

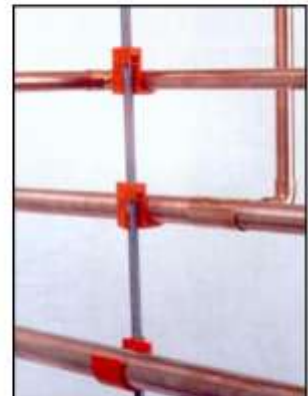

2010—PHCC North Texas Associate Members

AG Van & Truck Murray Clark	First Cardinal Raeshel Parker	ProStar Marketing Jack Stringer & Mark Stokes
Apex Supply Mike Williams & Don McDonald	Fuelman DFW Julie Handley	Rainbow Int. S. Tarrant Co. Steven Simpson
Atmos Energy Bridget Wallace & Ronnie Frazier	Great SW Support Services Carol Anders	Reliable Chevrolet Cheryl Fulgham
Braswell & Associates Ken Reinhardt	Hugh Cunningham Hal Haas	Skillful Improvement Ray Dettmer
Champion Marketing Hunter Gordon	Jahns Supply Paul Bradley & Ken Pittman	Sleeper, Sewell Insurance Spencer McClenahan & Travis Gibson
Classic Chevrolet Herb Rolph	Land Cannon Restoration Scott Pritchett	Spartan Tool Mark Lincoln
Compusource, Corp Len Woodruff & Mark Sandburg	Leasing Associates Ken Weese	Staff One, Inc. Clifford Clegg
Dillard Associates Mike Allen & Dave Campbell	L L Roberts Group Jim Tyler & L. J. Roberts	Sunstate Equipment Cary Stone & John Sheehan
Drain Doctor Charlie Sarao	Lubrizol Bryan Hutton & Jim Price	Symmons Industries Morris Watson
Enterprise Fleet Management Dannielle Martinez & Chris Hubble	MEMCO Casey Wenzel	Teter's Faucet Parts Jack Teter
Environmental Products of Texas Bob Fitzgerald	MeritCard Gabe Nickens	The Blue Book David Atterholt
Epic Supply Rody Ryon	Moore Supply Tony Fairless	The Steam Team John Kurek
Exxon Mobil Fleet Sales Leesa Patterson	Morrison Supply Mike Coffman	Toto, USA Brian Nickel
FC Background Melanie Laird	NIBCO John Seabaugh	Trade Source Si McCurdy
Fasest, Inc. Mark Oxler	Pepco Sales Steve Good	Viega, LLC. Jaime Gomez & David Randall
Federated Insurance Adam Beck	PlumbMaster Keith Prichard	Westway Sales Charlie Hall
Ferguson Enterprises Marc Cleere & Bill Jenkins	PrePaid Legal Elsom Eldridge	Winston Water Cooler Randy Hazzard

**PHCC of North Texas
Texas Hold'em Casino
Party**



SPONSORSHIP FORM

**Friday, January 22, 2010
Addison Conference Center
15650 Addison Road, Addison, TX**

**Every year PHCC North Texas has two Fund Raising Events
The Texas Hold'em Party is the first Event for 2010
If you would like to help Sponsor this Event Please Return this
form to the PHCC North Texas Office
(Sponsorship includes listing in the newsletter, web site & signage
at the event)**

SPONSORSHIP—\$225.00

Company Name _____

Phone # _____ **Fax** _____

Mail check to: PHCC of North Texas
4340 Highlander Drive
Dallas, TX 75287

For Info:
972-818-1990
Fax: 972-818-2105

Charge Card Type _____

Check _____

Number _____ **Exp** _____

Signature _____

**PHCC of North Texas
Texas Hold'em Casino**



**Party
NO LIMIT**



**Friday, January 22, 2010
Addison Conference Center
15650 Addison Road, Addison, TX**

Player Name (\$60.00) _____

Spectator Name (\$20.00) _____

Company Name _____

Phone # _____ **Fax** _____

**Mail check to: PHCC of North Texas
4340 Highlander Drive
Dallas, TX 75287**

**For Info:
972-818-1990
Fax: 972-818-2105**

Charge Card Type _____

Number _____ **Exp** _____

Signature _____

Limited to First 80 paid players

**Dinner - 6:00 – 7:00 pm Poker starts at 7:00 pm SHARP –
No one will be seated after play has started - Must be Paid in Ad-
vanced**

See Attached Sheet for Rules of the tournament

PHCC of North Texas Texas Hold'em Tournament

When: January 22, 2010 6:00pm until completion

POKER STARTS AT 7:00 SHARP

Where: Addison Convention Center

Who: The first 80 people to reserve a seat

Cost: Admission \$60 Donation to PHCC North Texas

1. This is a no limit Texas Hold-em Tournament.
2. The pay-out will be 50% of the net income, divided among the final eight players. (30% to first, 20% to second, 15% to third, 11% to fourth, 9% to fifth, 7% to sixth, 5% to seventh, 3% to eighth)
3. Each player will receive \$2,000 in chips.
4. Any time that a player's chip count drops below \$500 in the first two hours of play, that player may re-buy an additional \$1000 chips for \$20.
5. There will be two forced bets each hand. (beginning with \$25 smalls and \$50 big blinds). The blinds will double every thirty minutes
6. Every hour we will take a 10 minute break.
7. After the second break anyone still playing may buy an additional \$1,500 in chips for \$40. No other buy-ins are allowed after this point.
8. No one may pass or give their chips to any other player.
9. In the event the game is still in progress at midnight, the game will be stopped and the pot will be distributed to the winners based upon their remaining chip count.



Water Damage? Clean It Up!

CALL (214) FLOODED

and ask about our Plumber Referral Program

The Steam Team Service Includes:

- 24 hour Water Extraction
- Crawl Space Drying
- Large Scale High-Rise Drying and Dehumidification
- Content Packing and Storing
- Insurance Approval Pricing
- Residential and Commercial

**The
Steam
Team**

Fire & Water Restoration

The Steam Team, *Serving Texas Since 1984* • 8930 Diplomacy Row Dallas, TX 75247
www.thesteamteam.com • phcc@thesteamteam.com



Plumbing Supplies
Kitchen And Bath Showrooms

www.apexsupplyco.com
email: sales@apexsupplyco.com
Monday-Friday 7AM-5PM
Saturday 8AM-Noon

*Your
"Right Now"
Plumbing
Source*

MARKET CENTER

180 Oak Lawn
Dallas, TX 75207
214-741-5463 • Fax 214-744-4193

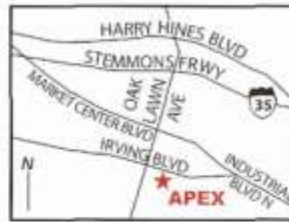

ARLINGTON

440 N. Watson Rd. (360)
Arlington, TX 76011
Metro 817-640-4343 • Fax 817-649-2960

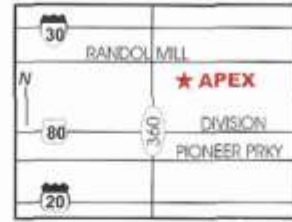

RICHARDSON

600 E. Arapaho
Richardson, TX 75081
972-231-5155 • Fax 972-231-5343



LEWISVILLE

510 S. Mill St.
Lewisville, TX 75067
972-436-1506 • Fax 972-436-1508



EAST DALLAS

7930 Heinen
Dallas, TX 75227
214-388-3456 • Fax 214-381-5770

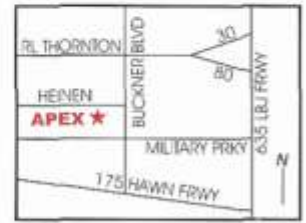

TERRELL

1100 E. Moore Ave.
Terrell, TX 75160
972-563-0046 • Fax 972-563-0146



SHREVEPORT

3909 Greenwood
Shreveport, LA 71109
318-631-1801 • Fax 318-636-5607

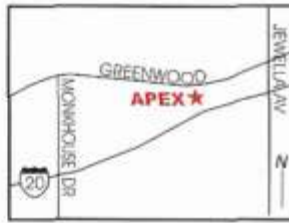

PARIS

1680 NE Loop 286
Paris, TX 75460
903-784-2569 • Fax 903-784-7357

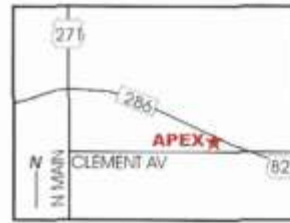

SULPHUR SPRINGS

200 Houston St.
Sulphur Springs, TX 75482
903-885-9559 • Fax 903-885-6083



Plumbing Supplies
Kitchen And Bath Showrooms
Monday-Friday 7AM-5PM

*Born
In Texas*

*Based
In Service*

FT. WORTH

2200 Montgomery St.
Ft. Worth, TX 76107
817-732-8183
Fax 817-732-8186

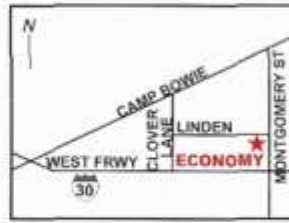

IRVING

820 N. Beltline Rd.
Irving, TX 75061
972-790-1550
Fax 972-790-1551

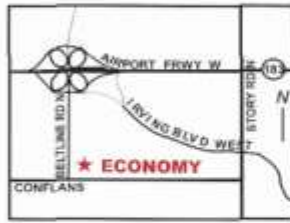

DALLAS/MARSALIS

127 N. Marsalis Ave.
Dallas, TX 75203
214-948-7547
Fax 214-948-7551

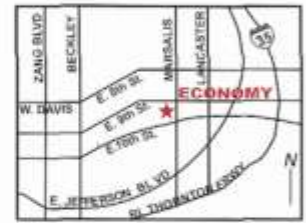

ROUND ROCK

808 Round Rock West Dr.
Round Rock, TX 78681
512-244-3326
Fax 512-244-6947



AUSTIN

4708 E. 7th St.
Austin, TX 78702
512-385-9160
Fax 512-385-9161



WACO

301 S. 15th St.
Waco, TX 76701
254-756-5306
Fax 254-756-5307



TETER'S
Faucet Parts Center

Large Inventory (214) 823-2153
 Knowledgeable Staff 6337 Oram Dallas, Tx.

Skillful
 Improvements & Restoration

Remodeling & Flood / Fire / Mold
 Ray Dettmer, CR, CKBR 972-279-0119
www.skillful.ws

2010 PHCC NORTH TEXAS BOARD OF DIRECTORS

President: Lee McFarland/Herndon/McFarland Vice President: Keith Powers/United Mech.
 Sec./Treasurer: Gary Seiferd/SPC Mech. Past President: Tony Cox/United Mech.

CONTRACTOR BOARD MEMBERS

Tommy Thompson/ACIS
 Howard Scarborough/ Alpha Plumbing
 Jimmie Dale/ Baker Brothers
 Fran McCann/Polk Mech.

ASSOCIATE BOARD MEMBERS

Mike Allen/ Dillard Associates
 Randy Hazzard/ Winston Water Cooler
 Raeshel Parker/ First Cardinal
 Rody Ryon/Epic Supply

INSPECTOR BOARD MEMBER : Clinton Stanford/City of Grand Prairie

The THOMPSON GROUP at CLASSIC

Experienced Professionals for Commercial & Fleet Vehicle Sales

Experience superior service before, during and after the sale from the #1 commercial vehicle specialty group of its kind in the Southwest.



**OVER 400 COMMERCIAL VEHICLES IN STOCK &
READY FOR IMMEDIATE DELIVERY.**

**2009 Chevrolet
Traverse**



**2009 Chevy Silverado
Crew Cab**



**2009 Chevrolet
Tahoe Hybrid**



**2009 Chevy
Box truck**



"KEN THOMPSON, the nation's #1 Chevrolet Salesperson for 31 consecutive years makes his home at the Nation's #1 Volume Chevy Dealership – **CLASSIC CHEVROLET.**"



*Now with 2
Locations to
Serve You!*

**Grapevine
Arlington**

PERSONAL · BUSINESS · FLEET
The Thompson Group
CLASSIC
CHEVROLET

Metro
817-410-1560

www.classicfleet.com



Two Men & A Truck



Visit www.morsco.com for a complete list of locations.

MORRISON SUPPLY COMPANY

2901 Trade Center Drive
Carrollton, Texas 75209

311 East Vickery Blvd.
Fort Worth, Texas 76104

Contact: Mike Coffman

214.869.2228
24/7 Hotline



We understand that as a business owner you have a number of issues to deal with on a daily basis; we're business owners too! But your credit card acceptance and card processing should be a seamless part of what you do. With over 60 years of combined experience on our side, we want to help you secure a competitive processing rate with unparalleled service. Let MeritCard help your business run smoothly, as a partner that can support you now and as you grow into the future.

MeritCard Solutions
311 S. Central Expressway
Dallas, TX 75201
P. (877) 39-MERIT (63748)
F. (877) 49-MERIT
www.MeritCard.com

MeritCard is a registered ISO of Wells Fargo N.A.

Let MeritCard help you focus on what you do best...leave your credit card processing to us!



- ✓ Savings - Lowest rate on credit and debit
- ✓ Service - Reliable 24 hour Customer Service
- ✓ Simple - Process with a Local Company



Call Gabe at ext. 4303
and ask about our
wireless terminal special



PHCC NORTH TEXAS &
CompPAC
That Of Texas



The 11th Annual Golf Tournament
SPONSORSHIP FORM
 Tuesday, April 20, 2010
 BROOKHAVEN GOLF CLUB
 3333 Golfing Green Drive, Dallas, TX
 Dinner and Awards Will Follow

SPONSORSHIP LEVELS

Masters Platinum: Receives special recognition and Team Entry	\$800.00 _____
Masters Gold: Receives special recognition and Tent on the course	\$500.00 _____
Eagles: Receives recognition and One Player Entry	\$325.00 _____
Birdies: Receives recognition on course	\$200.00 _____
Closest to the Pin:	\$300.00 _____
Longest Drive:	\$250.00 _____

Company _____ Contact _____

Phone _____ Fax _____ E-mail _____

Payment Options:

Check ___ Credit Card: Visa: ___ Master Card: ___ Amex: ___

Credit Card # _____ Exp: _____

Authorized signature: _____

***** Yes, my company would like to support PHCC North Texas and Mary's House*****

Please Complete This Form and Mail or Fax to:

PHCC North Texas, 4340 Highlander Drive, Dallas, TX. 75287

Fax: 972-818-2105

Questions: PHCC North Texas @ 972-818-1990 e-mail blochridge@sbcglobal.net



A Portion of the Profits will go to the support of Mary's House



PHCC NORTH TEXAS &

THE **Comp**PAC
PLC OF TEXAS



**The 11th Annual Golf Tournament
PLAYER REGISTRATION FORM**

Tuesday, April 20, 2010

1:00 pm Shotgun Start

Fee for golfing:

\$125 per player/ \$500 per team

BROOKHAVEN GOLF CLUB

3333 Golfing Green Drive, Dallas, TX

Dinner and Awards Will Follow

Please Complete This Form and Mail or Fax to:
PHCC North Texas, 4340 Highlander Drive, Dallas, TX. 75287
Fax: 972-818-2105
Questions: PHCC North Texas @ 972-818-1990
e-mail blochridge@sbcglobal.net

Payment is for: Individual _____ Team _____ Check _____ Credit Card _____

Card Number _____ Exp: _____

Authorized Signature _____

Company _____ Contact _____

Phone _____ Fax _____ E-mail _____

Team Member Names:

1. _____ 2. _____

3. _____ 4. _____



A Portion of the Profits will go to the support of Mary's House



GED Exam Preparation in Spanish

Preparación del Examen de GED en Español

20 sessions / 60 hours

COVERS ALL FIVE (5) SUBJECTS!



Tuesdays 10/20/09 – 04/06/10

(Winter Break 12/22 - 1/12)

Time: 5:00 PM – 8:00 PM

Tuition: \$300

Materials: TBA (approx. \$60)

Location: DFW Education Center

1401 N Royal Lane Irving 75063

This course is designed to help the participant gain a clear idea of what to expect and how to prepare for the General Educational Development (GED) examination. It is a guide to understanding the kinds of questions to expect on the 5 tests of the exam. The course is self-paced, so that attendees who study and prepare extensively will advance through the material at a rapid rate. There will also be ample time for participants who need more review of material.

Course objectives are to give the students a fair and reasonable explanation of testing procedures, scoring information and useful test-taking hints. There are 3 full-length practice tests that will give participants an understanding of what to expect in order to take the tests and pass the GED exam.

**Call 972-574-5200
for more information**

REGISTRATION INFORMATION (All information is required)

Name:	Company:
Social Security Number:	Company Address:
Date of Birth: Gender: <input type="checkbox"/> Male <input type="checkbox"/> Female	Company City/State/Zip:
Home Address:	Work Phone: ()
Home City/State/Zip:	Work Fax: ()
Home Phone: ()	Cell Phone: ()
Email:	Date Today:
Ethnicity: <input type="checkbox"/> White, Non Hispanic <input type="checkbox"/> Asian/Pacific Islander <input type="checkbox"/> Black, Non Hispanic <input type="checkbox"/> American Indian/Alaskan Native <input type="checkbox"/> Hispanic/Mexican American <input type="checkbox"/> Other (specify)	

Method of Payment:

<input type="checkbox"/> Invoice – for Sponsoring Association Members only (ABC, ASA, QUOIN)	<input type="checkbox"/> Business Credit Card (MasterCard, Visa, American Express, Discover)
<input type="checkbox"/> Deduct from CEF Trust Fund Account	<input type="checkbox"/> Personal Credit Card (MasterCard, Visa, American Express, Discover)
<input type="checkbox"/> Check or Money Order State _____ DL# _____ – mail/deliver with registration form – Do not fax.	

Company Authorized Name (please print) _____ Title _____

Company Authorized Signature _____ Date _____

Cardholder Address: _____ City _____ State _____ Zip _____ Cardholder Name (please print): _____

Card #: _____ Exp. Date: _____ Cardholder Signature: _____

By signing this registration form, you agree to the registration, payment, book/materials returns, and course drop policies as they are stated in the CEF Catalog. If you have any questions please don't hesitate to contact our office.

Please return registration form along with your payment to: Construction Education Foundation, Inc.
P.O. Box 612107 (mailing) 1401-A Royal Lane (physical) • DFW Airport, Texas 75261-2107 (872) 674-6200

For Office Use Only:

<input type="checkbox"/> CC Registration	<input type="checkbox"/> CC Accounting
<input type="checkbox"/> CC Trng Contact	<input type="checkbox"/> CC Scholarship
<input type="checkbox"/> Entered _____	
<input type="checkbox"/> Pending _____	

Fax (972) 574-3440 • www.ntcef.org

JOURNEYMAN/TRADESMAN PREP COURSE

Presented by Plumbing Heating Cooling Contractors North Texas

www.phccnorthtexas.org

Dates: *(Please circle date of your choice)*

January 16-17, 2010 February 27-18, 2010 March 20-21, 2010

April 17-18, 2010 May 22-23, 2010 June 26-27, 2010

Location: ARS Rescue Rooter
2411 Minnis Drive
Haltom City, TX 76117

Instructor: Howard Scarborough (Lunch is not Included)

Time: 8:00 - 5:00 pm Each Day

Cost: \$295.00—Member
\$395.00—Non Member

CREDIT CARD , CASH, MONEY ORDER—NO PERSONAL CHECKS
MUST REGISTER IN ADVANCE—CLASSES LIMITED

Name: _____ Company _____

Address of Company _____ City _____ State ____ Zip _____

Business Phone: _____ Fax: _____

Personal Phone/Cell Phone _____

Charge Card Type _____ Number _____ Expiration _____

Signature: _____ Your Test Date in Austin _____



Plumbing • Heating • Cooling
Contractors Association

PHCC North Texas/4340 Highlander Dr./Dallas, TX 75298
972-818-1990/972-818-2105-fax



Plumbing • Heating • Cooling
Contractors Association

Fax Back to: 972-818-2105

PHCC North Texas Lunch Meeting

January 19, 2010

11:30—1:00 pm

Location:

Brookhaven Country Club

3333 Golfing Green Drive

Dallas, TX

Program: Nancy Jones, PHCC Texas

Doug Turner, PHCC Texas President

Jane Hanna, CEF

Todd Iocco, Green Plumber Instructor

No I will not be there _____

Yes I will be there _____

Names _____

Company: _____

Thank you for helping us with this.

Barbara & Aggie

PHCC North Texas
4340 Highlander Dr.
Dallas, TX 75287

972-818-1990
972-818-2105-fax

www.phccnorthtexas.org

Email:
blochridge@sbcglobal.net